

1700 Division Street, New London, WI 54961

Phone: (920) 982-4030; Fax: (920) 982-6800

Website: www.nleco.com

High-efficiency gravity roller conveyor series with a range of frame and roller options designed to meet the needs of most common industrial conveying applications.

Between Frame Widths: 12" – 36" (Custom Widths Available)

Lengths: 6" – 10'0" Sections

Rollers: 2 5/8" Diameter x 7 Gauge Tube, 11/16" Hex Axle, 650 Pound Roller Rating

Frame: 4" x 5.4 Pound, Structural Channel

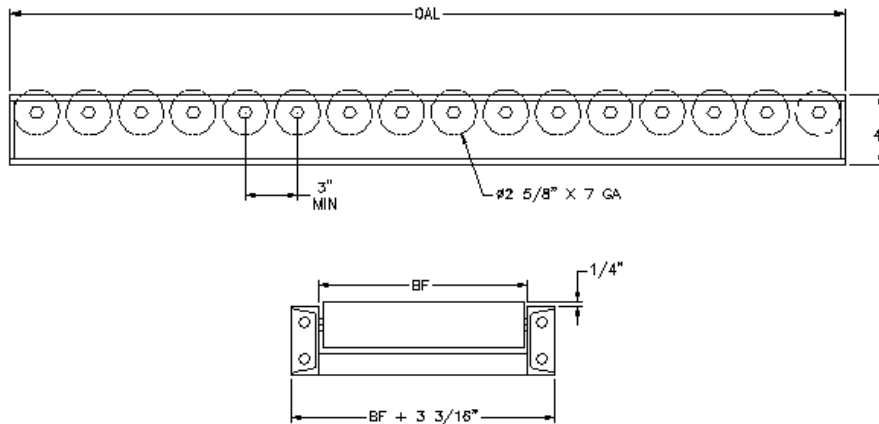

M921-ROLLERS HIGH

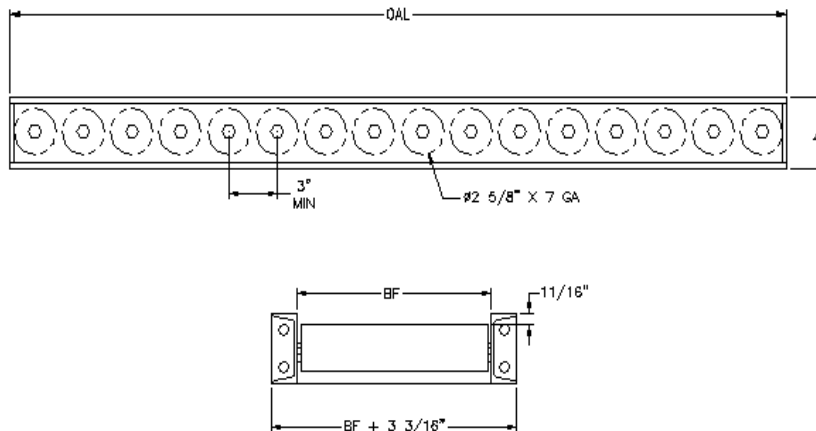

M921-ROLLERS LOW